

BMW G650X (K15) Tail Rack and pannier frame model G650PFTR-01 Installation instructions

Thank you for purchasing the BMW G650X tail rack and pannier frame.



This tail rack will fit all BMW Models that share the K15 motorbike sub-frame: 2007-2009 XChallenge, XMoto and XCountry).

Earlier K15 bikes (2007) were built with an aluminum sub-frame. These bikes are not designed to take heavy loads so exercise caution when installing this pannier frame. The loads should not exceed more than 5kg per hoop and 5Kg for the tail rack, for a total of 15 kg combined.

What's included in the kit:

- Tail Rack unit with Stainless steel plate installed
- Right Hoop Assy
- Left Hoop Assy
- Left sub-frame bracket
- Right sub-frame bracket
- License plate reinforcement plate
- Left side rear bar
- Right side rear bar
- Cross brace
- Hardware (metric): 1 allen head M8x45mm, 4 allen head M8x20mm w/ nylock nuts and dual washers, 8 allen head M6x20mm w/ nylock nuts and dual washers, 4 allen M6x15mm flat head, license plate plastic spacers.

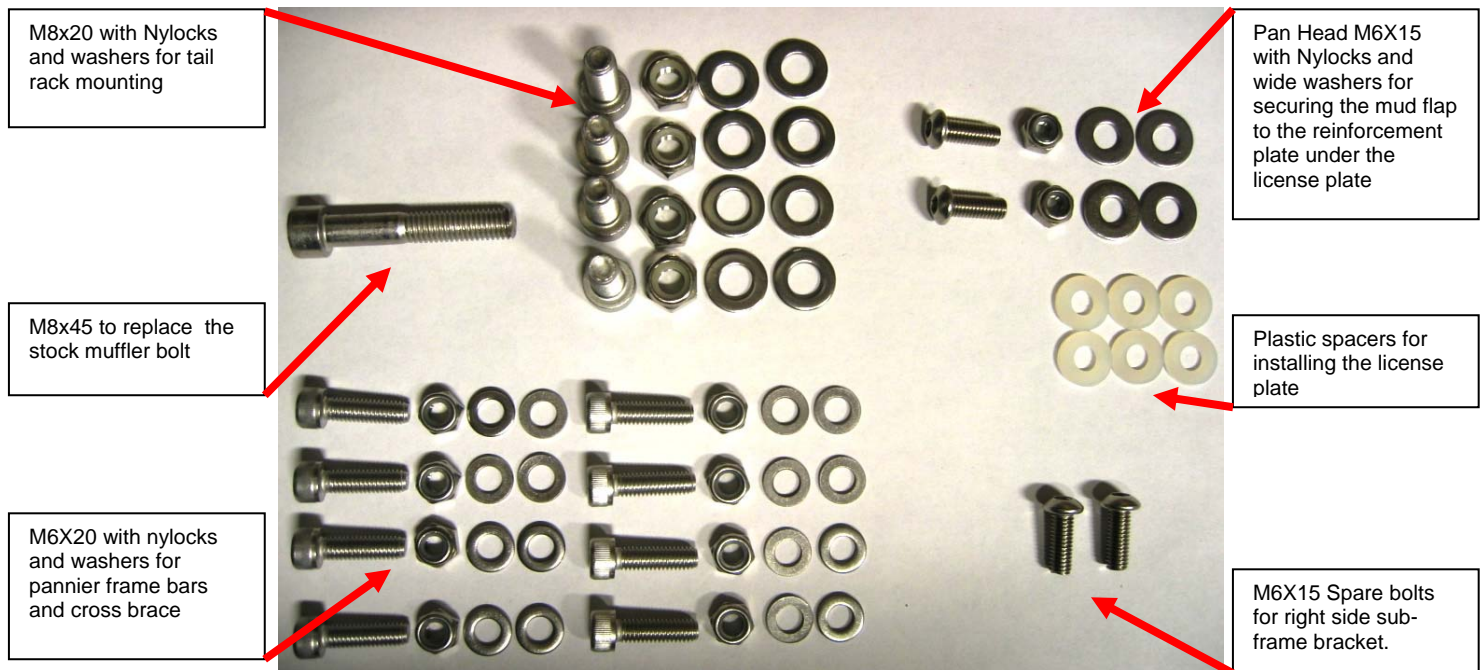
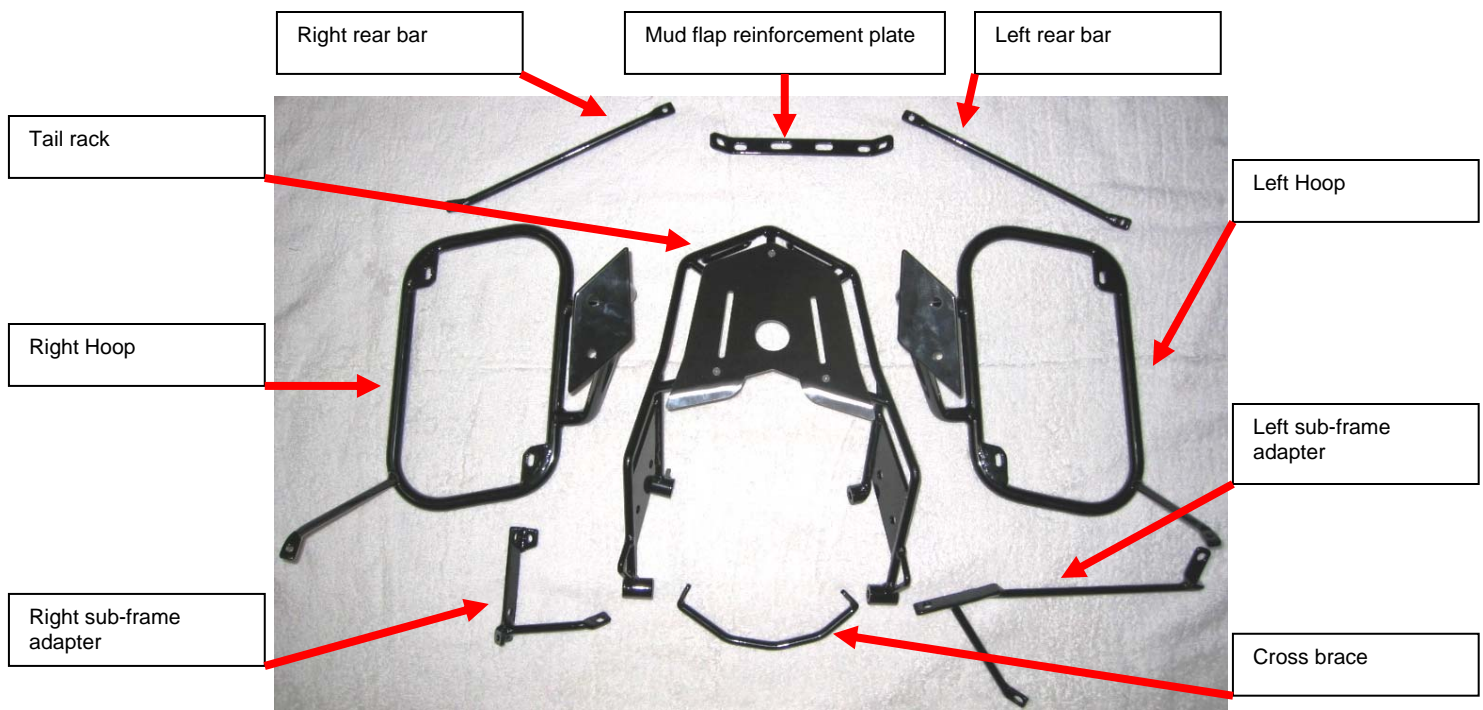

The hoop decorative plates shown are optional.

Tools Required:

- Inbus/Allen wrench M8, M6
- Socket 8mm, 6mm
- Torque Wrench with 5-60Nm range or equivalent in lbs/ft (1Nm=0.737lbs/ft)

Installation instructions:

1. Ensure the bike is cold and the silencer is cool to touch
2. Remove the bolt that holds the silencer to the chassis (Fig1)



3. Loosen up the clamp bolt that holds the silencer pipe to the exhaust manifold pipe
4. Slide out the silencer. Be careful not to damage the heat gasket between the silencer pipe and the exhaust manifold pipe.
5. Use InBus/Allen key 8mm and remove the 4 bolts holding the pillion handle (G650XCountry only) as per picture below.



6. Unpack the pannier and tail rack kit and identify the components. The unit can be installed in two distinct configurations:
 - o Just the tail rack and the sub-frame components for installing pannier components later
 - o The full assembly as a tail rack and pannier frame.
7. First install the tail rack and tighten the bolts using a torque wrench to **10Nm** and also apply **Loctite 243**. Note that the spacers that were originally installed with the handles are no longer required.
8. Remove the two bolts installed on the sub-frame on the right side of the bike. Note that this installation applies to Canadian, Euro and some US models that don't have the charcoal canister installed. For those models that have the charcoal canister installed, one would have to research on alternate methods of installing the canister back.
9. On the muffler side, carefully remove the bolt that holds the plastic wheel cover and save the small aluminum spacer. This spacer is no longer needed with the pannier frame installation.
10. The two sub-frame brackets are pre-fitted with heavy duty double sided tape. Before attaching them, please peel off the red portion.

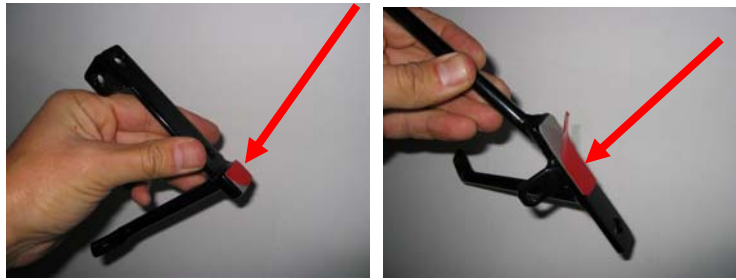

11. Install the two pieces as shown in the picture. Re-use the original 6mm bolts for the brackets attaching to the sub-frame and the longer 45mm bolt for the muffler. Tighten the bolts securing the brackets to the sub-frame by hand. Avoid tightening too much. Use on each bolt a drop of **Loctite 243**.

Re-use Existing washers but replace the bolt with the longer one (45mm) provided. Tighten to **25Nm**



Re-use existing bolt. The small aluminum washer is no needed but save it. Tighten by hand and apply **Loctite 243**

Re-use original bolts or use the two spare panheads M6X15 Tighten by hand and apply **Loctite 243**

12. Once the two sub-frame pieces are secured, install the cross brace. As per attached picture.

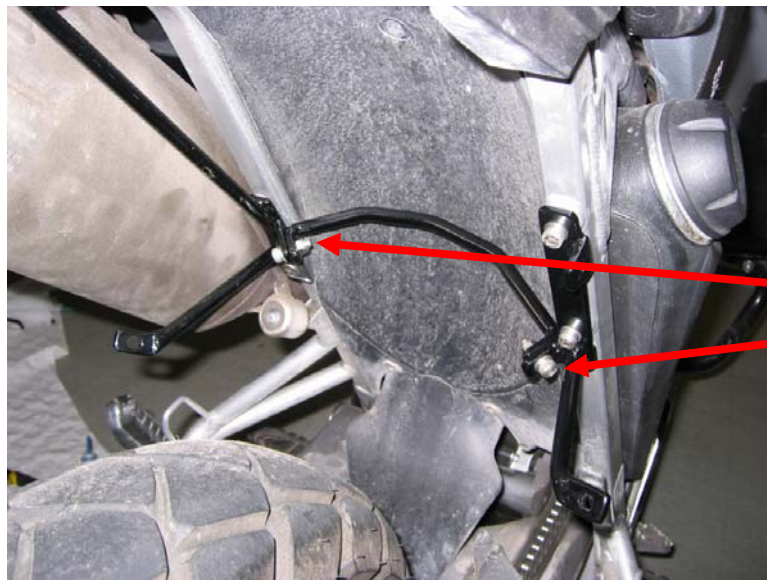

Install cross brace. Use M6x20 and tighten bolts to **10Nm**

13. Install the silencer by carefully sliding into the exhaust manifold pipe and resting into the frame stud as per Fig4 and tighten bolt to rear frame at **25Nm** and the exhaust manifold clamp bolt at **10Nm**.



Silencer frame rest stud

14. At this point, if the pannier frame is not needed, the installation is complete. Proceed further if the side hoops of the pannier frame are required.
15. Remove the license plate. Some models have the extended mud flap. This installation assumes that this mud flap has been removed already for as tail tidy look. Center the mud flap reinforcement plate and tighten the bolts.



Mud flap reinforcement plate. Use M6x15 panheads and large washers

16. Position the pannier hoops on each side of the bike and carefully adjust and slightly secure the bolts on the tail rack plates as well as on the two sub-frame adapters. Do not tighten the bolts yet! This step needs to be done on each side for proper alignment.



17. Ensure the hoop frame bar plate is positioned as per picture below on each side:

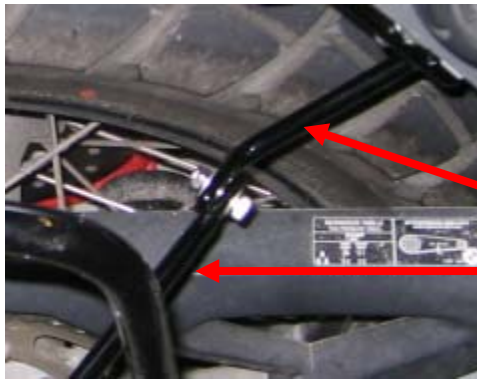

The hoop bar plate on top of the sub-frame adapter bar plate

18. Proceed by tightening first the hoop bars on the sub-frame adapter bars at **10Nm** then when everything is aligned properly, tighten the 4 bolts at **25Nm** to the tail rack plates.
19. The next and final step is to attach the rear bars to the mud flap reinforcement plate. Tighten the bolts at **10Nm**. Once this is complete install the license plate using 4mm spacers on the remaining two holes on the mud flap reinforcement plate.



License plate holes on Mud flap reinforcement plate. Use plastic spaces provided for installing the license plate

This unit was tested intensively in various conditions, however it is strongly not recommended exceeding the specified load on it, nor should anyone use it as a passenger seat. Safety also is something that comes with the riding style and weather conditions, so be careful and ride safe.

Specifications:

Hoop dimensions (approx outer perimeter):

Length= 30mm

Height= 20mm

Pipe Diameter: 16mm

Construction: 16mm steel pipe 2mm wall powder coated

Reinforcement Bars (solid steel) diameter: 10mm powder coated

Top tail rack plate: Brushed stainless steel

Hardware: Metric Stainless steel with Allen/Inbus heads with Nylock nuts.

Weight not including packaging: 6.15kg (of which the tail rack is 1.95kg and the pannier frame is 4.2kg)

Maximum load per hoop: 5kg

Maximum load per tail rack: 5kg
